

# Lewit m 60

Jordi Veciana  
2004

# metalarte

www.metalarte.com · metalarte@metalarte.com

Table lamps giving ambient light. Cylindrical shade in black or white chintz fabric. Upper diffuser in perforated metal sheet enamelled white. Metal structure in 5 x 5 mm square bar, enamelled black or white. Switching by means of on/off switch located in the electrical cable for the Lewit m40 version, and in the lamp-holder for the Lewit m47 and Lewit m60 versions.

<b>Environment</b>	Indoor
<b>Structure</b>	Metal
<b>Shade</b>	Chinz Fabric
<b>Voltage</b>	230 V
<b>Switching</b>	ON/OFF switch on the lamp holder
<b>Supply</b>	Electrical cable with plug
<b>Cable length</b>	250 cm

CE  750°

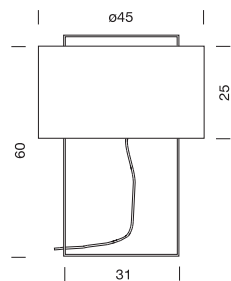

## Structure

448702500

448704700

White

Black

## Shade

810382500

810384700

White

Black

E27 Eco Hal. Max 70W 